

B O Y D



L O N D O N D O U B L E S C O N C E

#10153

SHOWN IN ANTIQUED BOYD BRASS

10153 London Double Sconce

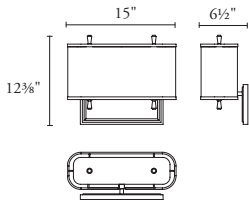

Height	Width	Projection	Net Wt.
12 ³ / ₈ "	15"	6 ¹ / ₂ "	9 lbs
314 mm	381 mm	165 mm	4.1 kg

Oblong shade: 15" L x 5¹/₄" D x 7³/₄" H;
381 x 133 x 197 mm

Backplate: 11" L x 5" H; 292 x 140 mm

Center of outlet box to top of fixture:
9⁵/₈"; 244 mm

For ADA compliance, height of center of outlet box above finished floor:
80⁵/₈"; 2048 mm

UL listed (or equivalent) for damp locations

Beveled mirrored backplate

Shade: white linen with black trim

Bottom diffuser: white acrylic

Optional top diffuser: white perforated metal diffuser (upcharge)

Optional: mirror mount modification available

LAMPING

Incandescent

- Two, Medium base, A-15, 60w max each (ceiling fan lamps)

Lamps not included with fixture.

STANDARD FINISHES

- Antiqued Boyd Brass
- Blackened Brass

SPECIALTY FINISHES

- Satin Nickel

OPTIONAL

- Top diffuser

10152 London Single Sconce

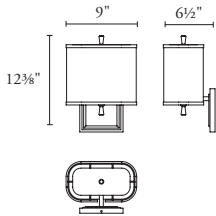

Height	Width	Projection	Net Wt.
12 ³ / ₈ "	9"	6 ¹ / ₂ "	6 lbs
314 mm	229 mm	165 mm	2.7 kg

Oblong shade: 9" L x 5¹/₄" D x 7³/₄" H;
229 x 133 x 197 mm

Backplate: 5¹/₂" square; 140 mm

Center of outlet box to top of fixture:
9⁵/₈"; 244 mm

For ADA compliance, height of center of outlet box above finished floor:
80⁵/₈"; 2048 mm

UL listed (or equivalent) for damp locations

Beveled mirrored backplate

Shade: white linen with black trim

Bottom diffuser: white acrylic

Optional top diffuser: white perforated metal diffuser (upcharge)

Optional: mirror mount modification available

LAMPING

Incandescent

- One, Medium base, A-15, 60w max (ceiling fan lamp)
- Compatible with LED Screw-in lamps

Lamp not included with fixture.

STANDARD FINISHES

- Antiqued Boyd Brass
- Blackened Brass

SPECIALTY FINISHES

- Satin Nickel

OPTIONAL

- Top diffuser

