

# BOYD LIGHTING

**C-10049  
PRESIDIO  
CEILING**

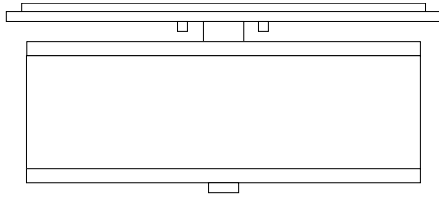

## INSTRUCTIONS FOR INSTALLATION

**IMPORTANT: READ ALL  
INSTRUCTIONS THOROUGHLY  
BEFORE PROCEEDING.**

**CAUTION: TURN OFF POWER AT  
CIRCUIT BREAKER OR FUSE BOX  
BEFORE PROCEEDING.**

## INSTALLATION: PRESIDIO CEILING

1. Carefully remove fixture from packaging. Avoid using sharp blade on packaging as it may damage the finish or the fabric shade.
2. Attach mounting bracket to the outlet box.
3. Mount canopy assembly to the mounting bracket. Use the two decorative knobs to secure the canopy assembly to the ceiling.
4. Install white perforated metal diffuser over the neck assembly and turn so it will hang from the neck assembly. (See Fig 1)
5. Assemble the light cluster to the shade placing the white mounting disc above the shade and securing with decorative nut. (See Fig 2)
6. Make wire connections using the twist-on connectors: connect black fixture wire to black supply wire; white fixture wire to white supply wire; fixture ground wire to ground wire or terminal. Push all connections inside outlet box.
7. Push the fixture/shade assembly up to the neck assembly and over the two threaded studs. Use thumb knobs to secure the fixture/shade assembly to the neck assembly. (See Fig 3)
8. Install type "A" lamps/bulbs; do not exceed 60-watt max.
9. Install bottom acrylic diffuser and secure with the decorative bottom finial. (See Fig 4)

Figure 1

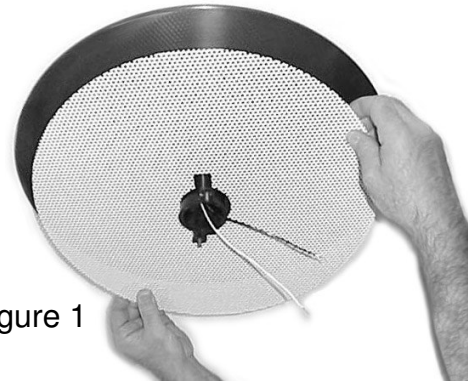

Figure 2

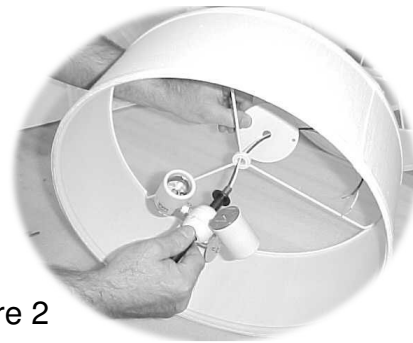

Figure 3

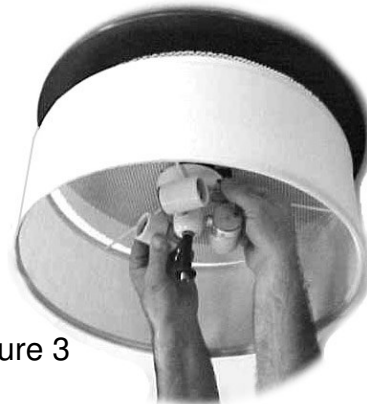

Figure 4

